

- NOTES:
1. DIMENSIONS WITHIN THE PARENTHESES ARE METRIC UNITS (millimeters) or (Kg=Kilograms)
 2. MATERIAL: FIBERGLASS REINFORCED POLYMER (FRP)
 3. WEIGHT. COLUMN: 83 Lb. (37.6 Kg)
CAP: 8 Lb. (3.6 Kg)
BASE: 15 Lb. (6.8 Kg)
 4. MATERIAL THICKNESS.
COLUMN: 3/8" (9.5)
 5. INSIDE DIAMETER AT TOP OF COLUMN: 6 5/8" (168.3)
 6. OUTSIDE DIAMETER AT TOP OF COLUMN: 7 1/2" (190.5)
 7. INSIDE DIAMETER AT BOTTOM OF COLUMN: 8 3/4" [222.3]
 8. OUTSIDE DIAMETER AT BOTTOM OF COLUMN: 9 5/8" (244.5)
 9. TAPER STARTS 24.0" (609.6) FROM BOTTOM OF COLUMN.
 10. 20 FLUTES

COLUMN PROJECTS 1/8" (3.18) ABOVE STANDARD CAPITAL.

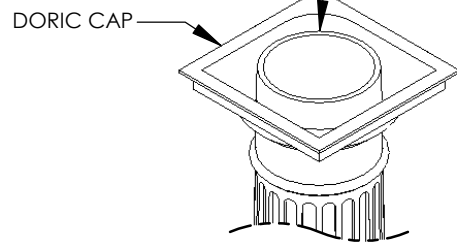

10" X 8' FLUTED COLUMN

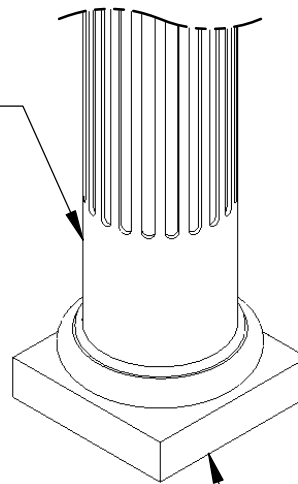

TUSCAN BASE

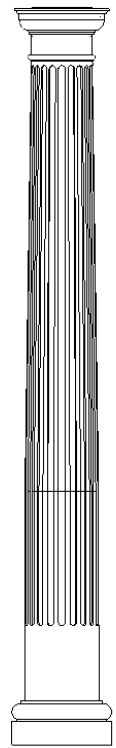

ARCHITECTURAL VIEW
SCALE 1/25

TUSCAN BASE



888-514-8141

		DIMENSIONS ARE IN INCHES (mm) TOLERANCES: FRACTIONAL: ± 1/8" ANGULAR: MACH ± BEND ± TWO PLACE DECIMAL ± THREE PLACE DECIMAL ±		NAME	DATE
			DRAWN	SOF	05/05/08
		MATERIAL	CHECKED	RK	
			ENG APPR.	RK	
		FINISH	MFG APPR.	RK	
			Q.A.	RK	
NEXT ASSY	USED ON		COMMENTS:		
APPLICATION		DO NOT SCALE DRAWING			

©COPYRIGHT

10" X 8' FLUTED COLUMN
W/DORIC CAP
& TUSCAN BASE
ASSEMBLY

SIZE	DWG. NO.	REV.
A		02
SCALE: 1/12	WEIGHT:	SHEET 1 OF 1